



USER INSTRUCTIONS

BELLEVUE WALL AJ9

BY ARNE JACOBSEN
1929

Congratulations on choosing this original Bellevue wall lamp designed by Arne Jacobsen. We hope you will enjoy using this product and follow these instructions to ensure correct installation. If you have any questions or comments, please do not hesitate to contact us by mail on:

info@andtradition.com

CONTENTS

- A - Wall lamp fitted with 2 meter cord
- B - 2 x screws for wall bracket
- C - Wall bracket

Please read these instructions carefully and retain them for future reference to ensure that the lamp is used correctly. For your own safety, please study each step of this instruction manual first. &tradition is not responsible for any faults or damages caused by not following these instructions correctly. Do not modify this lamp in any way.

INSTALLATION SUGGESTIONS

The Bellevue wall lamp is ideal as a reading lamp for the bedroom, office or living room. The flexible swan-neck design keeps the shade in place exactly where you need the light directed. Combine this lamp with the floor and table versions and visit our website for more inspiration:

www.andtradition.com

TOOLS NEEDED

- Correct screws and plugs for the specific wall type where the lamp is to be installed.
- Electric drill, screwdriver, 2.5 mm Hex / Allen key, and spirit-level.
- Bulb type: E14 Max 40W.

SAFETY PRECAUTIONS

- Dispose of plastic bag from packaging and do not allow children to play with it.
- Keep product well out of children's reach.
- The lamp is only intended for interior use.
- Lamp exterior gets hot after prolonged use.
- Do not attempt installation of product if you are not competent to do so yourself.
- Consult a professionally qualified electrician if in any doubt.
- Disconnect the electricity supply at the fuse box, before commencing work.

CLEANING INSTRUCTIONS

The Bellevue lamp is made from solid brass and lacquered aluminum. The brass used is uncoated and will therefore develop a unique and beautiful patina over time. To ensure the lamp will look beautiful for years to come, please only use a dry soft cloth to clean the lamp. Never use aggressive detergents or abrasive cleaning agents as this will damage the surface of the lamp.

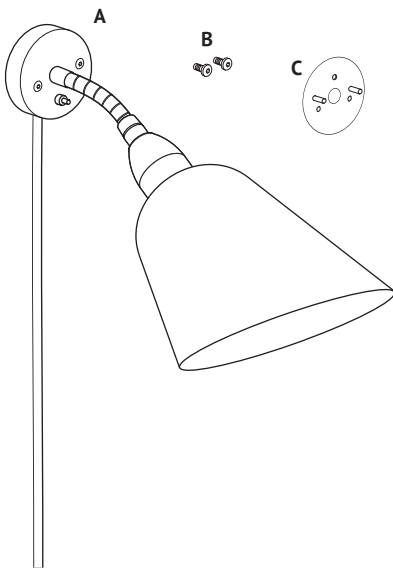

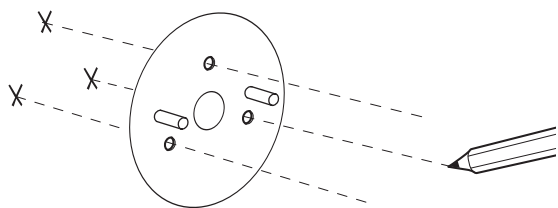

STEP 1

Ensure the power cord can be connected so it is not over-stretched or an obstacle. Place the wall mounting on top of a spirit level in the desired location for the lamp. Ensure the mount is level and mark the placement of the holes with a pencil.

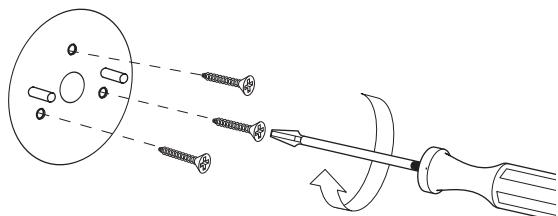

STEP 2

Drill the holes for the bracket and use the correct type of screw and plug for the type of wall which the lamp is to be fitted to. Tighten the screws and ensure the bracket is safely fixed in place.

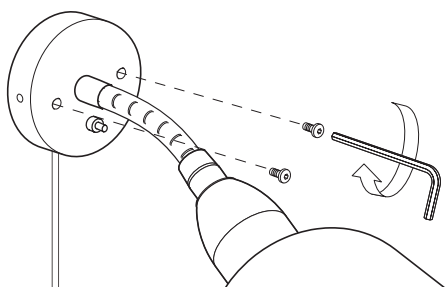

STEP 3

Place the lamp over the wall-bracket. Align the screw holes of the lamp with the bracket and tighten the screws with a 2.5 mm Hex / Allen key.

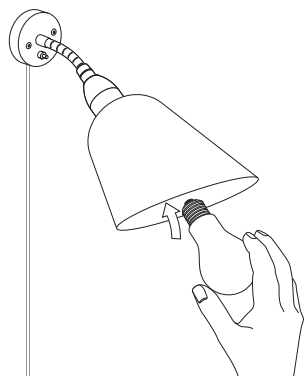

STEP 4

The lamp accepts standard screw mount bulbs:

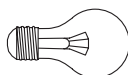

E14 Max 40W.

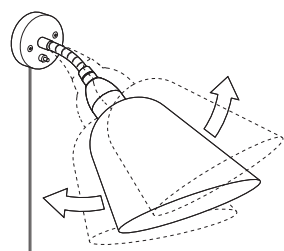

STEP 5

Use the flexible swan-neck to set the shade at a desired angle. It is best to set the angle before turning the lamp on as the shade gets hot when the lamp is in use for longer periods of time.

220-240V - 50 Hz



& tradition®