

## KOLLAGE HOOK

by Michael Rem

Instruction

- ① Mark on the wall where you want to place your flowerpot. Drill a 10 mm hole and put in a wall plug.

Marker hvor på væggen du ønsker at placere din Kollage Flowerpot. Bor et 10 mm hul og indsæt en rawlplug.

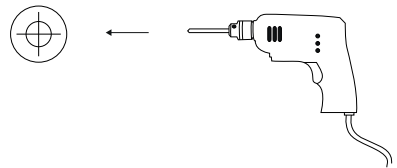

- ② Place the allen key in a hole in the bushing and tighten firmly. Make sure that one of the holes with a thread, is pointing upwards.

Sæt unbrakonøglen i et hul i bøsningen og spænd til den sidder stramt mod væggen. Et af hullerne med gevind skal vende opad.

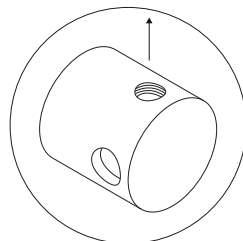
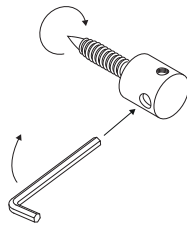

# GEJST

- ③ Place the hook on the bushing.  
Placer Kollage Hook på bøsningen.

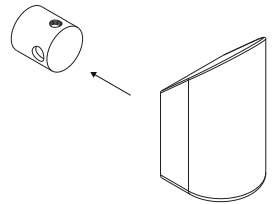

- ④ Fasten the hook by fastening the remaining screw from the bottom.  
Spænd Kollage Hook fast ved at skrue skruen i fra bunden.

