

## NIVO

by Böttcher & Kayser

### Instruction

①

Choose in which way, you would like to mount the Nivo shelf.  
Make markings on the walls according to the drawing.

Drill 6 mm holes in each of the six markings.

Beslut hvordan du ønsker at montere din Nivo hylde.  
Marker på væggen hvor de seks skruer skal sidde.

Bor et 6 mm hul i hver af de seks markeringer.

①

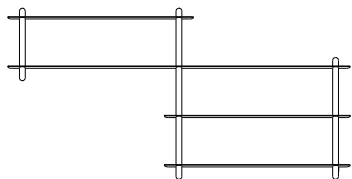

②

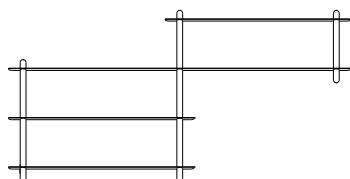

③

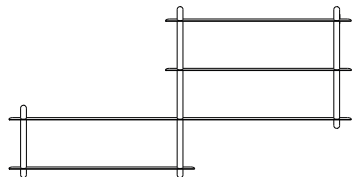

④

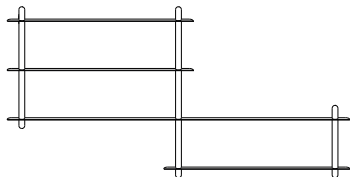

①

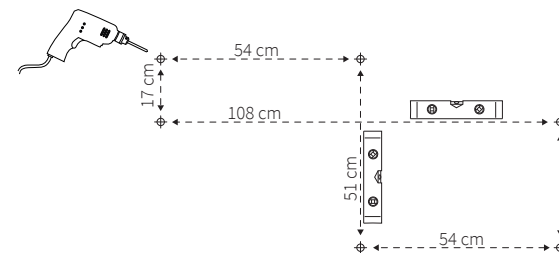

②

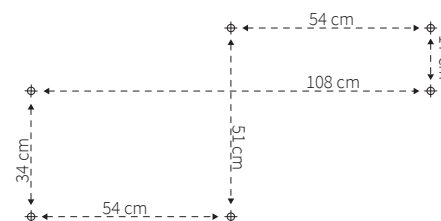

③

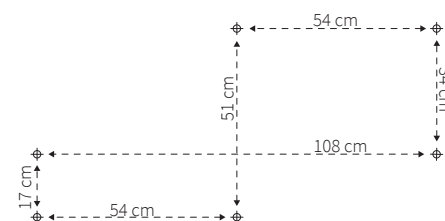

④

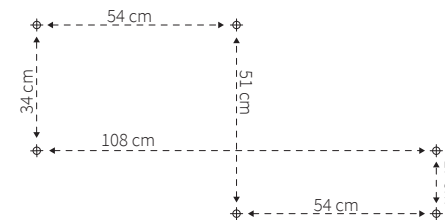

- ② Insert rawplugs in all six holes and fasten the screws 5 mm from the wall.

Indsæt rawplugs i alle seks huller og skru skruerne i, så de er 5 mm fra væggen.

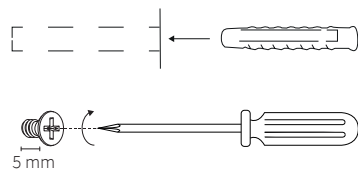

- ③ Place the pole on top of the screws and slide it downwards onto place. Repeat with the two other poles. Make sure the pole is facing the correct way.

Placer stolpen vertikalt over skruerne, og skub den ned til den ikke kan komme længere. Gentag med de to andre stolper.

Sørg for at stolperne vender den rigtige vej.

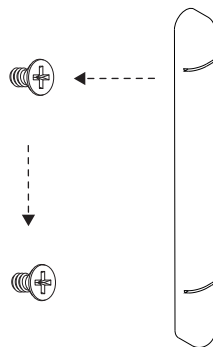

- ④ Place the first shelf in the slits on the poles, so the holes in the shelf is covered by the center of the slits.

Repeat with the other three shelves.

Placer en hylde i rillerne på stolperne, så hullerne i hylde er centreret i rillen.

Gentag med de tre andre hylde.

